

BIG – Biuletyn Informacyjny Gort (Gort Newsletter)

News in offer!

Meeting you expectations we have created a fantastic product – Refrigerated Cabinet for Fish and Sea Food, previously cooled to storage temperature in order to keep their taste and aesthetic values, which are of importance as for fast Moving Consumer Goods. Exterior and interior are made of stainless steel AISI 304, what allows keeping the highest standards of hygiene and durability.

Features:

- ✦ technical data: according to table
- ✦ digital controlling system with temperature display
- ✦ rated to ambient temperature up +43°C
- ✦ polyurethane insulation 60 mm
- ✦ static cooling
- ✦ magnetic door basket, removable
- ✦ removable side rails for easy and precise cleaning
- ✦ ecological cooling factor R404a
- ✦ self-closing hinged door (by opening < 90°)
- ✦ working space accommodates standardized containers 600x400x160mm
- ✦ door's stainless steel handle integrated with door
- ✦ adjustable stainless steel feet
- ✦ bottom plug
- ✦ power supply 230V/50 Hz
- ✦ Internal temperature: -1°C ÷ +1°C
- ✦ maximum load: 200 kg
- ✦ 7 containers for fish, 600x400x160 mm with s/s perforated input



There is possibility to equip the Refrigerated Cabinet for Fish with castors (two with brake), tone warning alarm of opened door and temperature register.

Code	Version	Door	Capacity [L]	Power [W]	Int. dimensions [mm]	Ext. dimensions [mm]
CMR1103-070GG	stainless ASI304	1 (full); right	700	650	576x690x1524	700x895x2040

Practical advice:

- Ø One should remember that the products stored in the containers should be put on crushed ice.
- Ø Cooling system ensures keeping constant temperature and prevents from drying up of products stored on the condition that door opening frequency will be limited and the cabinet will be cleaned regularly.
- Ø It is forbidden to use neither direct water stream for cleaning of the device nor abrasive, corrosive or based on chlorine materials which could scratch or damage the surface.
- Ø Condensate and waste after cleaning of the cabinet can be removed through the bottom outlet.
- Ø One should remember to close the bottom outlet with a bottom plug after cleaning of the interior.

Important news

In every kitchen background there are mounted shelves for microwave ovens, salamander ovens or other Heating appliances that is why one should think over its proper placing and dimensions. The offered strengthened shelf's maximum load is up to 22 kg and is made of stainless steel AISI 304. The shelf model AM711 can be produced with the following dimensions: 500÷800 x 400÷600 x 330 mm. While choosing the shelf and fixing its Dimensions one should take into account producer's recommendations concerning the distance between appliance and wall:

- for microwave oven – approximately 10 cm in the rear and 5 cm on the right and left side,
- for salamander oven – approximately 10 cm from every wall.

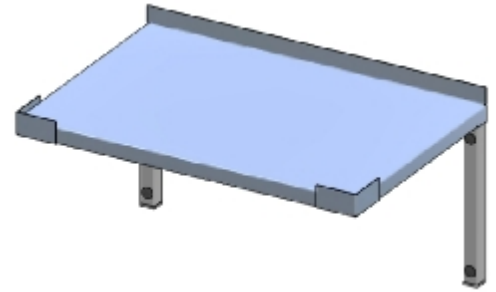

AM711

Realizations



We have delivered our equipment to a small kitchen background in a driver-inn in Sokółka. Ergonomic stainless steel tables: framework table, table with sink, cupboard with drawers' unit let to use the space efficiently. Kitchen background we have also equipped with appliances: wall mounted exhaust hood, steam – convection oven, gas cooking top with 4 burners and electric fryer installed on open cupboards. The wholeness is very functional and aesthetic.

